

SALES DRAWING

SALES DRAWING

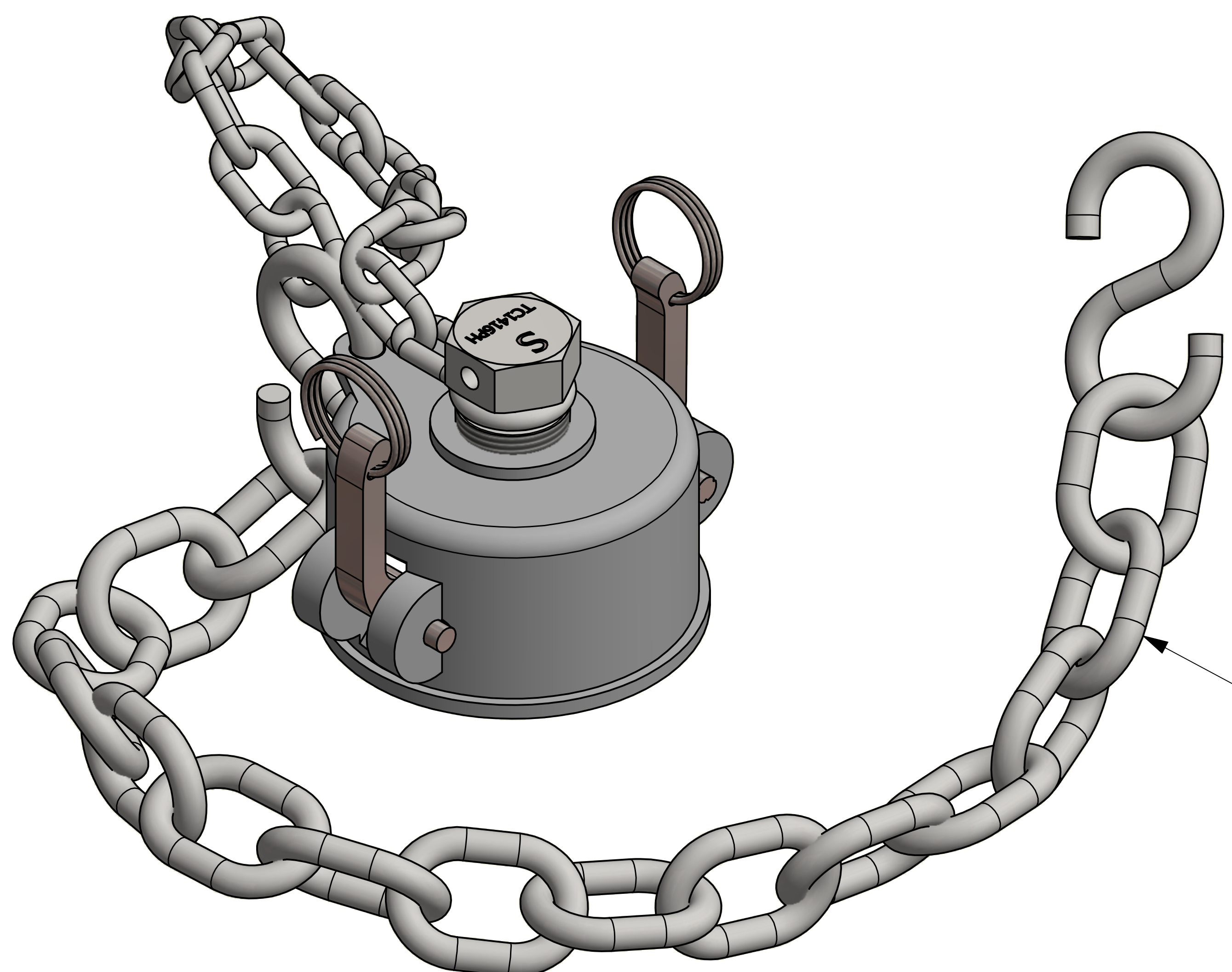

15 LINKS OF 3/8" STAINLESS STEEL CHAIN  
APPROXIMATE LENGTH 21"

**NOTES:**

1. THIS ASSEMBLY IS NOT DOT APPROVED AND CAN BE USED ONLY ON AAR STENCILED CARS.
2. QUICK DISCONNECT MEETS A-A-59326D.
3. CAP GASKET MATERIAL IS WHITE FDA NITRILE.
4. AAR APPROVAL # E-139514.

D	RJP	11-4-13	AAR APPROVAL # WAS E-039015, MIL SPEC WAS MIL-C-27487G
C	JRS	10-28-11	UPDATED TO NEW STANDARDS
B	CHL	12-29-03	AAR APPROVAL # WAS E-939034
A	FOD	3-6-00	UPDATED TO NEW STANDARDS
REV	BY	DATE	DESCRIPTION

<small>UNLESS OTHERWISE SPECIFIED DIMENSIONAL TOLERANCES</small> FRACTIONAL: ±1/16 X.XX: ±.03 X.XXX: ±.015 ANGULAR: ±1° <small>THIS PRINT, PROPERTY OF SALCO PRODUCTS INC, CONTAINS PROPRIETARY INFORMATION AND MUST NOT BE COPIED, REPRODUCED, OR USED DETRIMENTALLY TO OUR INTEREST.</small> THIRD ANGLE PROJECTION	DRAWN BY:	ACC
	CHECKED BY:	
	PROTOTYPE BY:	ACC
	PROTOTYPE DATE:	12/8/1999
	APPROVED FOR PRODUCTION BY:	ACC
	PRODUCTION DATE:	12/8/1999

**SALCO PRODUCTS, INC.**

PART NAME: **QUICK CONNECT CAP 3" KAMMED**

MATERIAL: **STAINLESS STEEL**

PROJECT #: **981123** SHEET #: **1 OF 1** SCALE: **1:1**

DRAWING #: **D14003** PART #: **K3SDC2A**